

Montage-handleiding elektrokabelset voor  
trekhaak met 13-P contactdoos  
vlgs. DIN/ISO norm 11446

Fitting instructions electric wiringkit  
towbar with 13-P socket up to  
DIN/ISO norm 11446

Einbauanleitung Elektrosatz  
Anhängervorrichtung mit 13-P Steckdose  
lt. DIN/ISO Norm 11446

Instructions de montage du faisceau  
électrique pour crochet d'attelage  
conforme à la norme DIN/ISO 11446  
prise 13-P

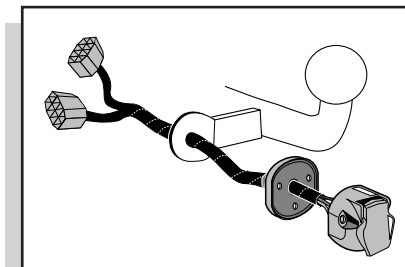

## AUDI A4 AVANT 1995- Without Check Control

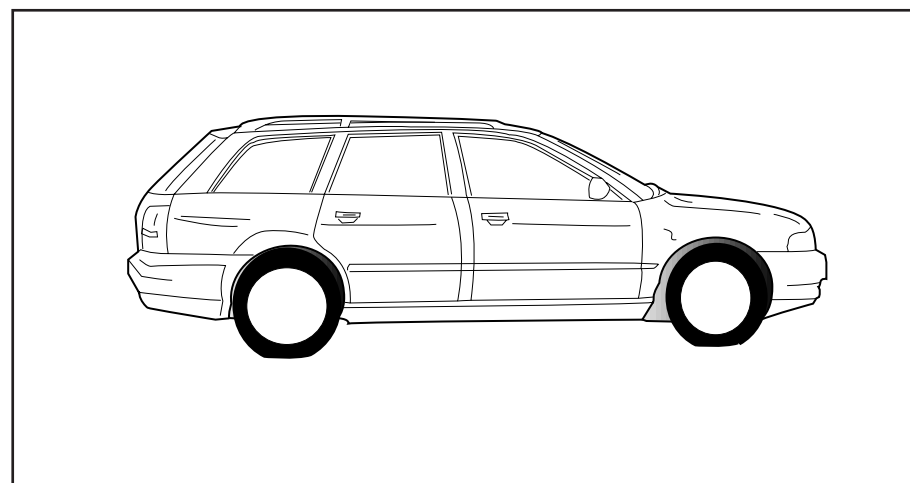

Bestel Nr.: VAG-939-L



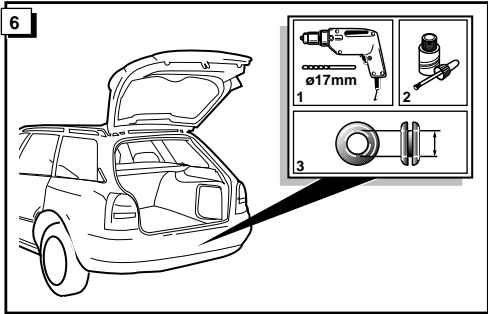
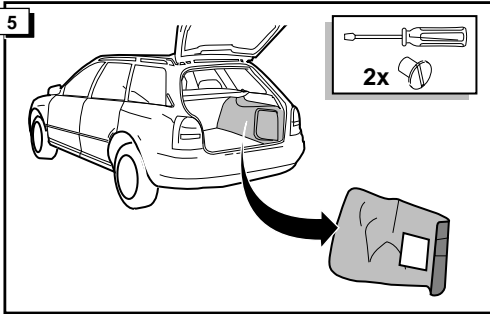
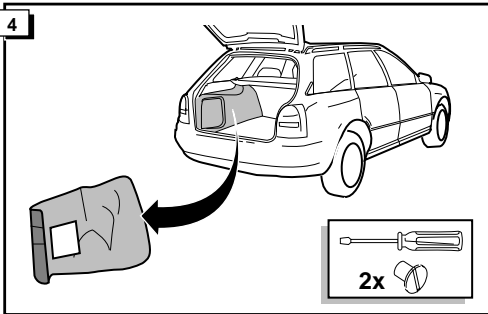
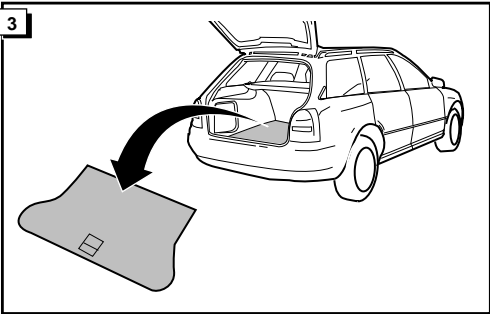
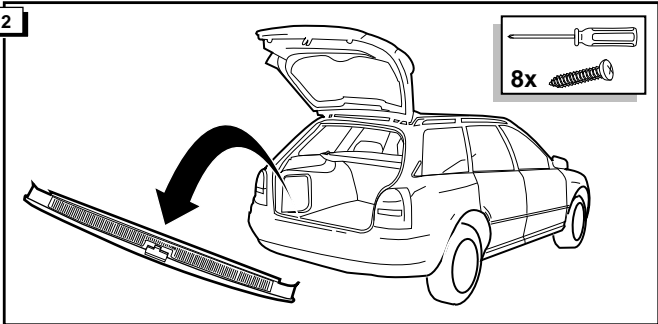
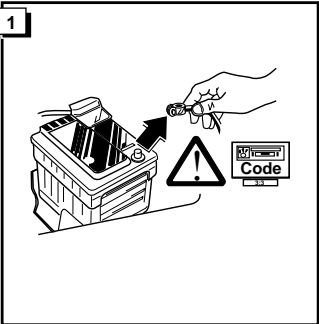
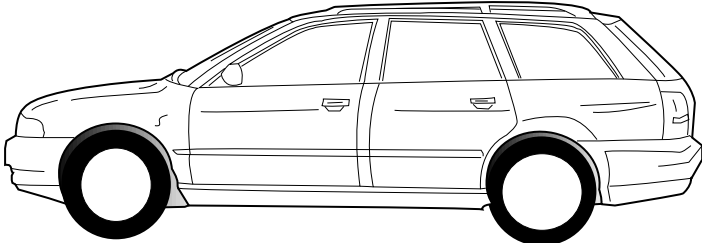

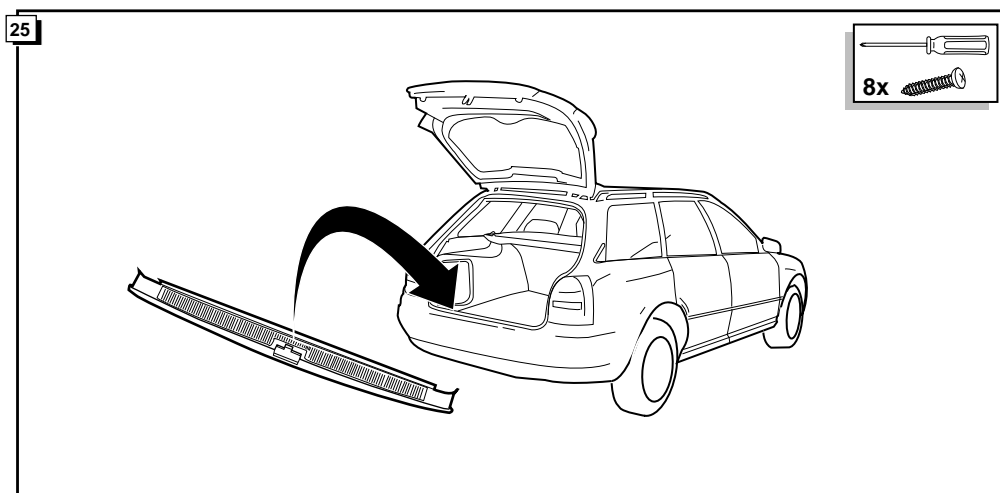
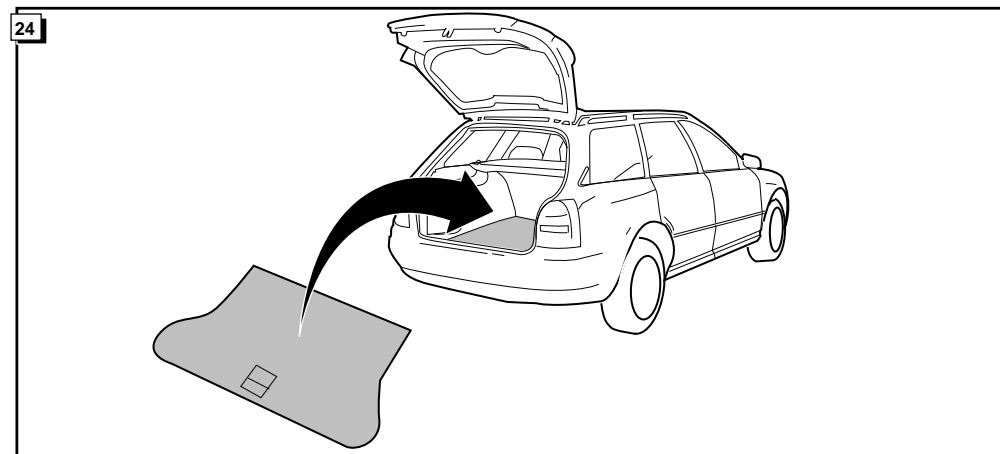
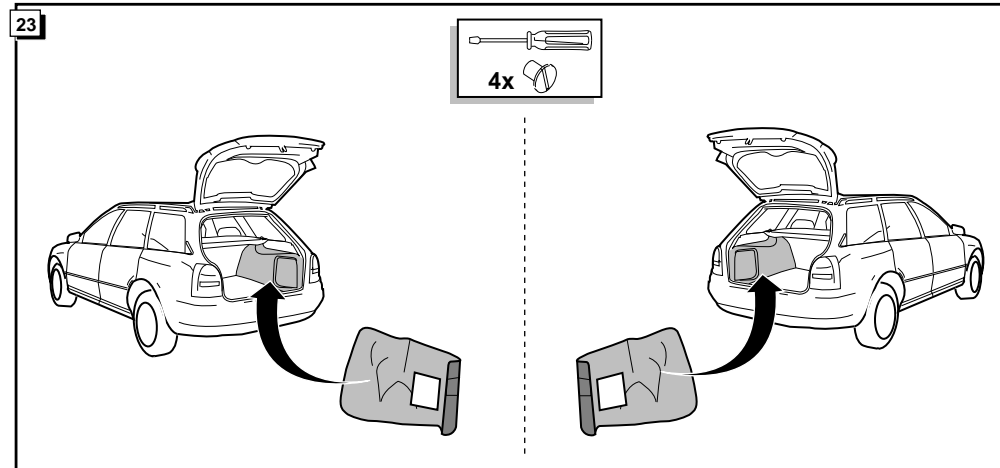
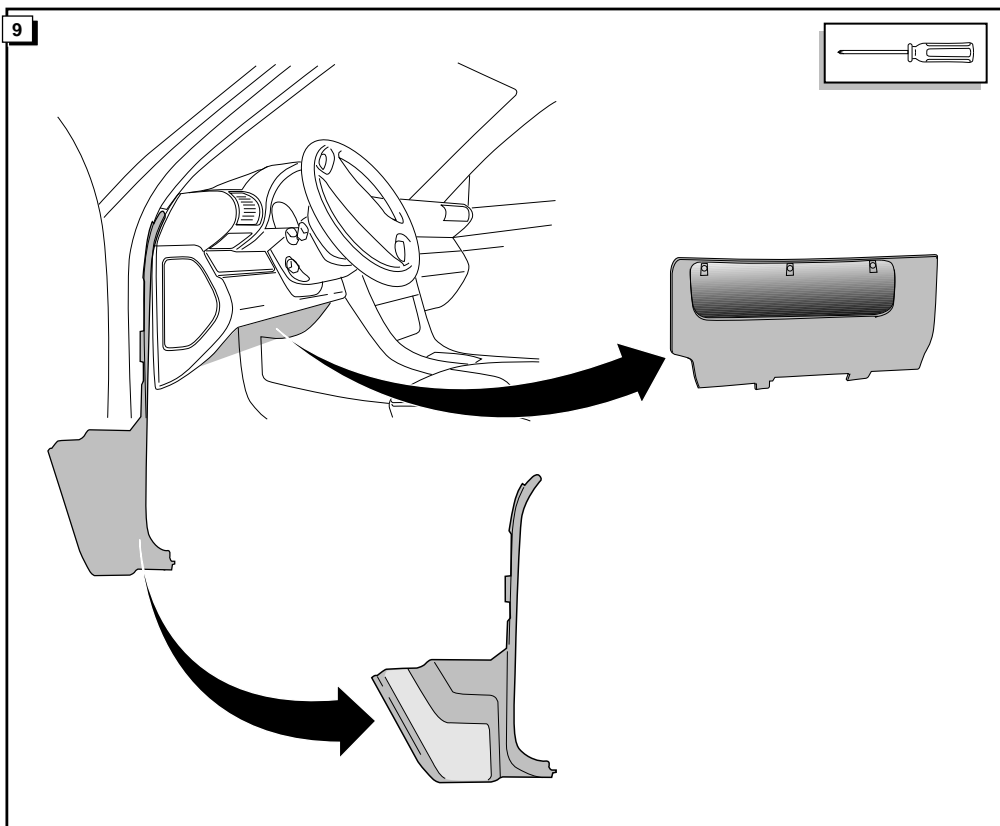
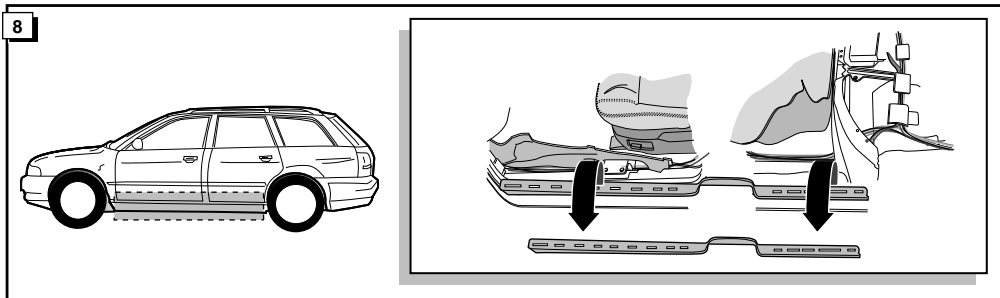
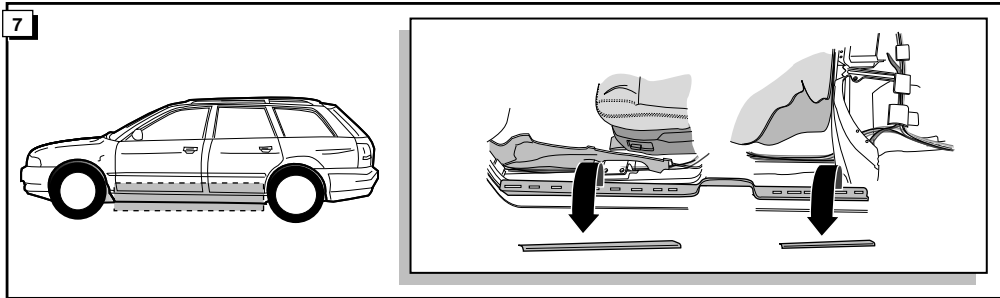

18

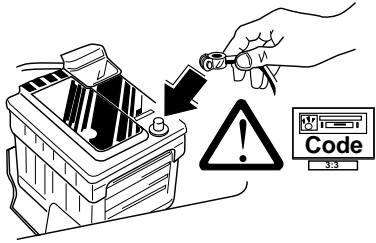

19

**CONTROLEER FUNCTIES !**  
**CHECK FUNCTIONS !**  
**FUNKTIONEN KONTROLIEREN !**  
**CONTRÔLER LES FONCTIONS !**

20

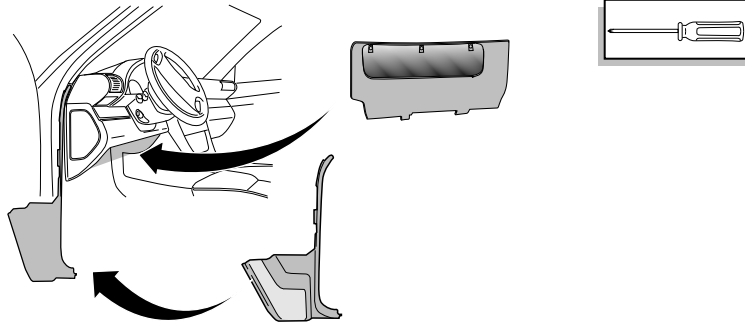

21

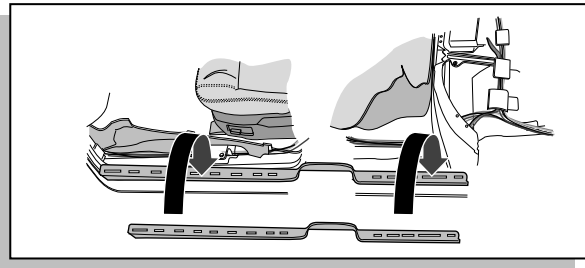
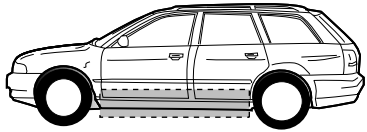

22

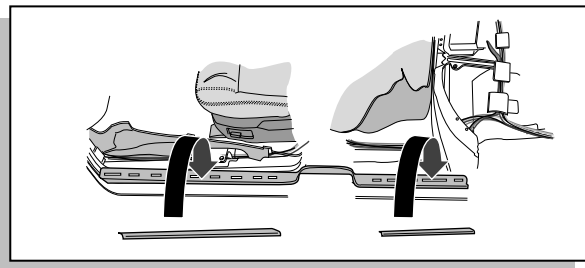
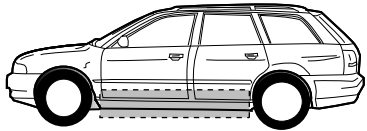

ROUTING

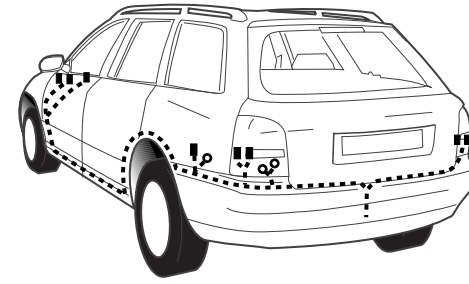

10

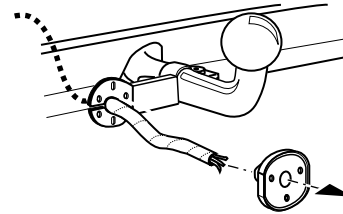

1

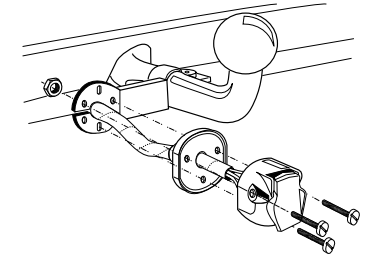

3

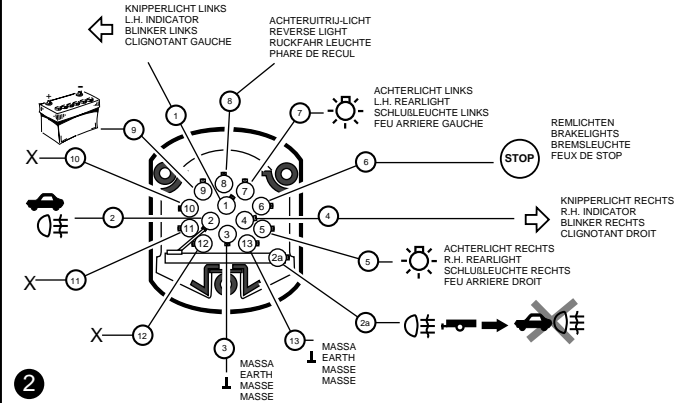

2

|        | NL     | GB     | D       | F       |
|--------|--------|--------|---------|---------|
| 1/L    | GEEL   | YELLOW | GELB    | JAUNE   |
| 2      | BLAUW  | BLUE   | BLAU    | BLEU    |
| 2a     | GRUIJS | GREY   | GRAU    | GRIS    |
| 3/31   | WIT    | WHITE  | WEIß    | BLANC   |
| 4/R    | GROEN  | GREEN  | GRÜN    | VERT    |
| 5/58-R | BRUIN  | BROWN  | BRAUN   | MARRON  |
| 6/54   | ROOD   | RED    | ROT     | ROUGE   |
| 7/58-L | ZWART  | BLACK  | SCHWARZ | NOIR    |
| 8      | ZW/WD  | BL/RD  | SCHW/RT | NO/RO   |
| 9      | BR/WI  | BR/WHI | BR/WE   | MAR/BLA |
| 10     |        |        |         |         |
| 11     |        |        |         |         |
| 12     |        |        |         |         |
| 13     | WIT    | WHITE  | WEIß    | BLANC   |

11

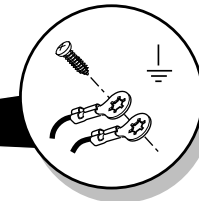
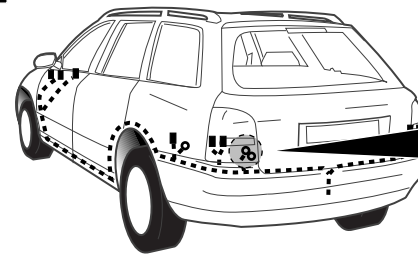

12

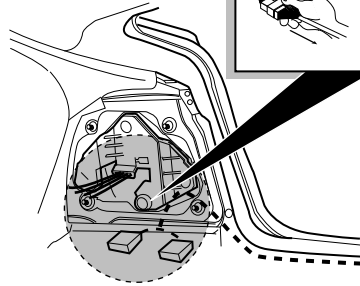
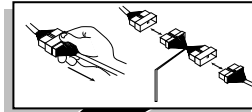
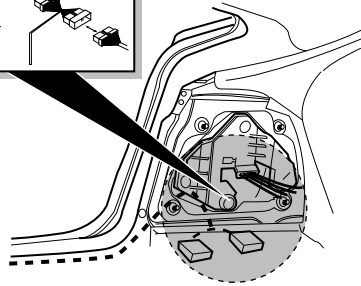
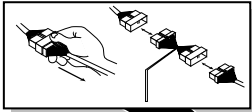
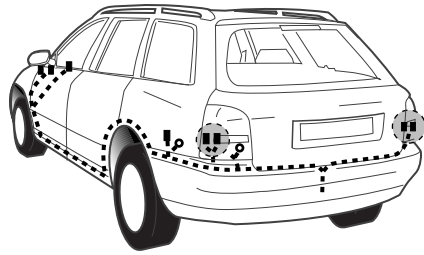

14

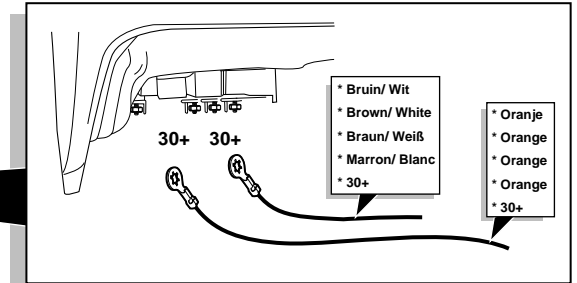
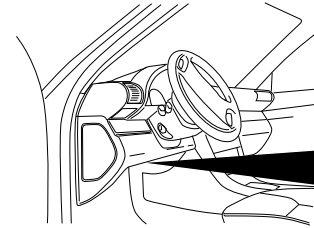
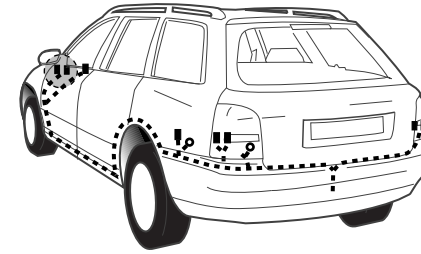

13

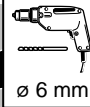
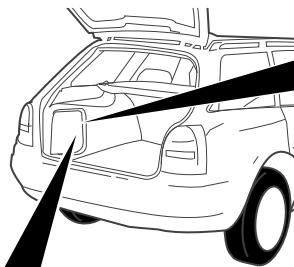
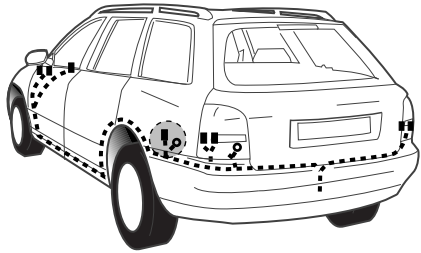

∅ 6 mm

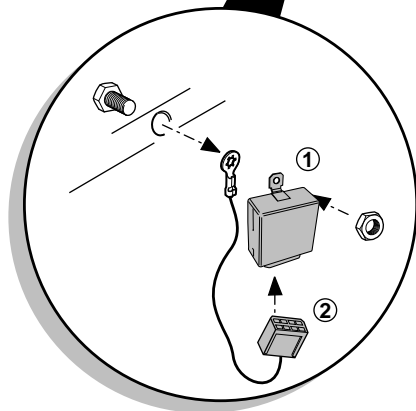
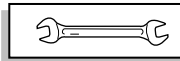

15

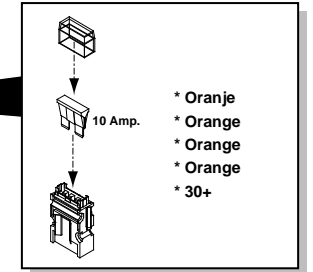
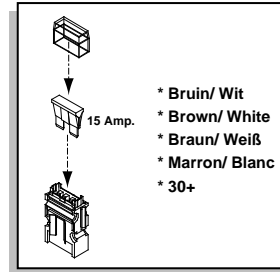

16

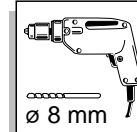
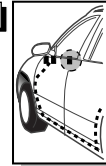

∅ 8 mm

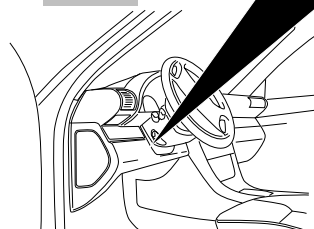

17

