

Einbauanleitung Elektrosatz
Anhängervorrichtung mit 13-P Steckdose
lt. DIN/ISO Norm 11446

Instructions de montage du faisceau
électrique pour crochet d'attelage
conforme à la norme DIN/ISO 11446
prise 13-P

Fitting instructions electric wiringkit
towbar with 13-P socket up to
DIN/ISO norm 11446

Montage-handleiding elektrokabelset voor
trekhaak met 13-P contactdoos
vlg. DIN/ISO norm 11446

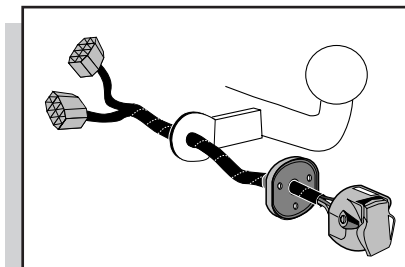

OPEL ASTRA Hatchback/Sedan 1998-

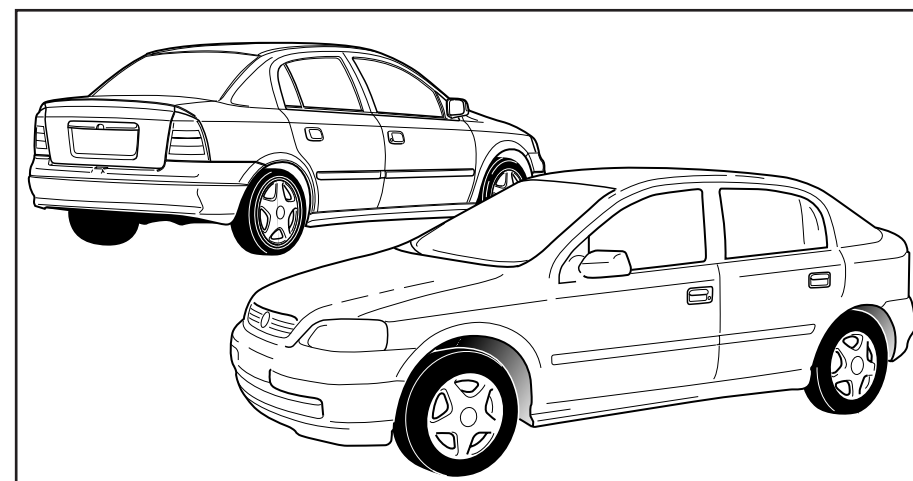

Bestel Nr.: OP-008-HB

* Teilliste * Liste de pieces * Part list * Onderdelenlijst

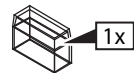
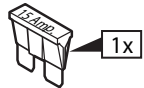
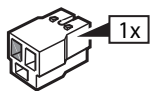
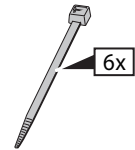
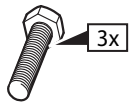
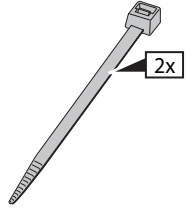
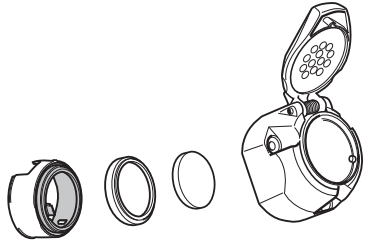
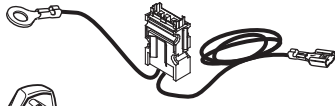
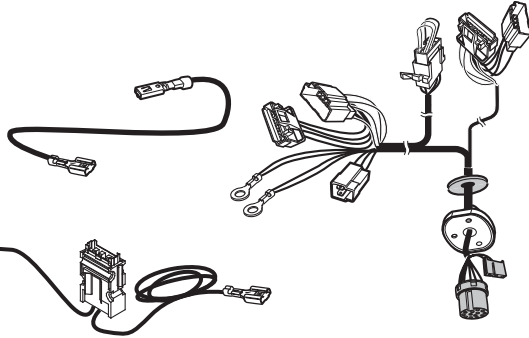
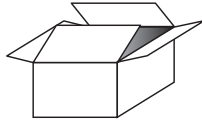

INFO

Die Kontrolleuchte blinkt, wenn beim angeschlossenen Anhänger die Blinker (3x21W) oder Warnblinkanlage (6x21W) eingeschaltet sind.

Le deuxième témoin de contrôle clignote lorsque les feux de détresses (6X21W) et les clignotants (3X21W) du véhicule sont allumés alors que la caravane/remorque est accouplée au véhicule.

By switching on flashers with the trailer connected (3x21W) or the warning lights (6x21W), the 2nd direction indicator light will flash.

Het controle-lampje knippert wanneer bij aangesloten aanhanger de knipperlichten (3x21W) of waarschuwingslichten (6x21W) ingeschakeld zijn.

1

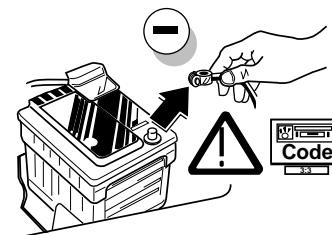

25

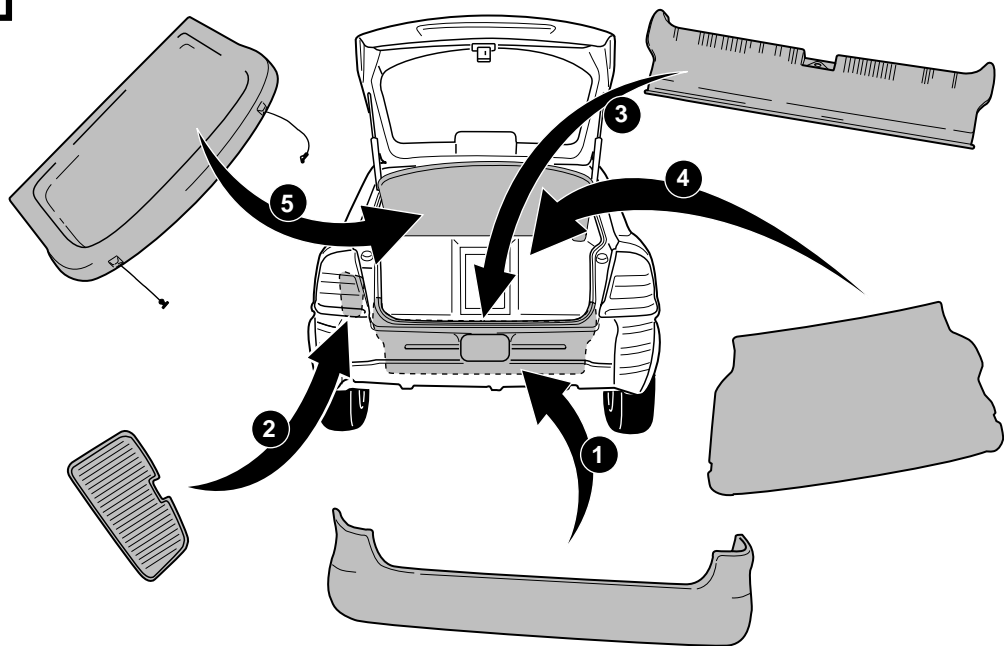

2

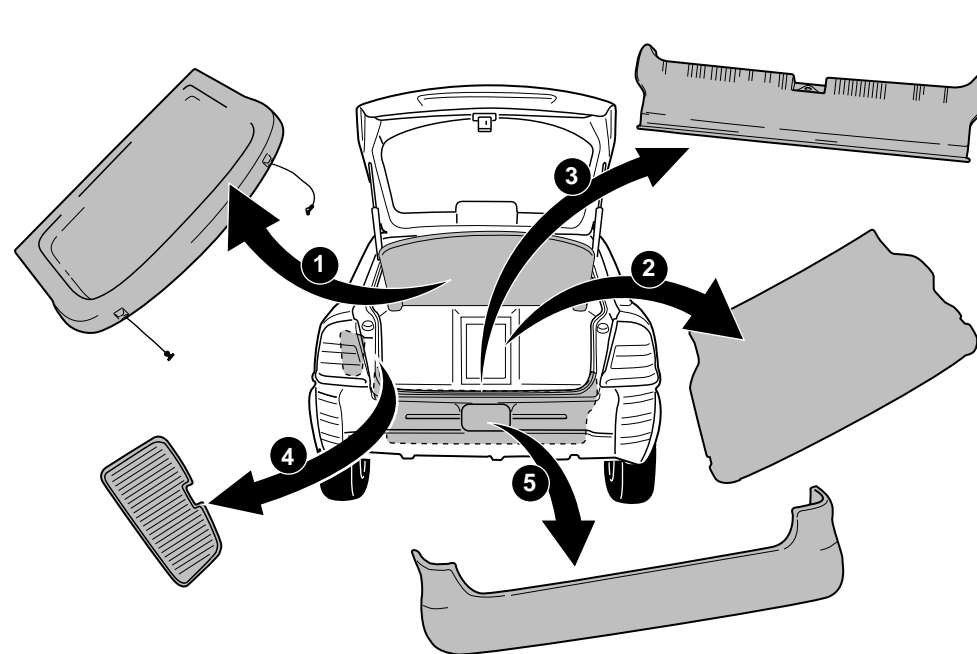

3

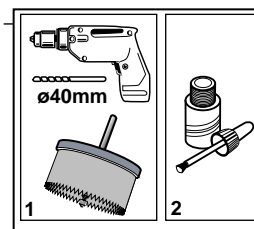
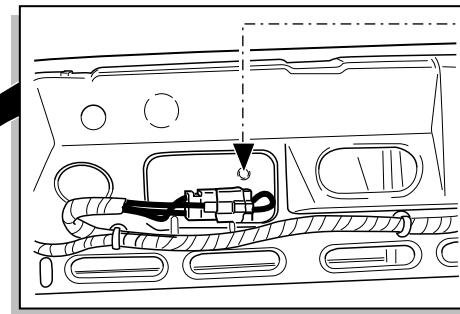
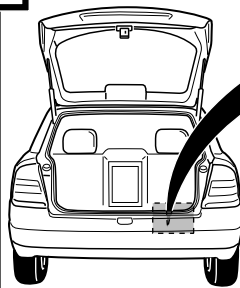

INFO

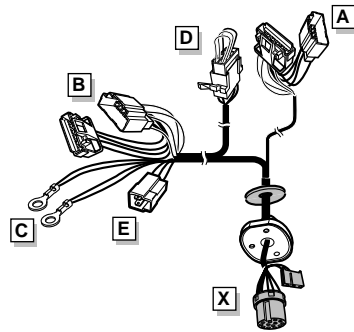

ROUTING

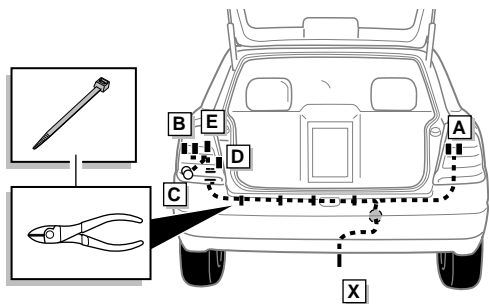

4

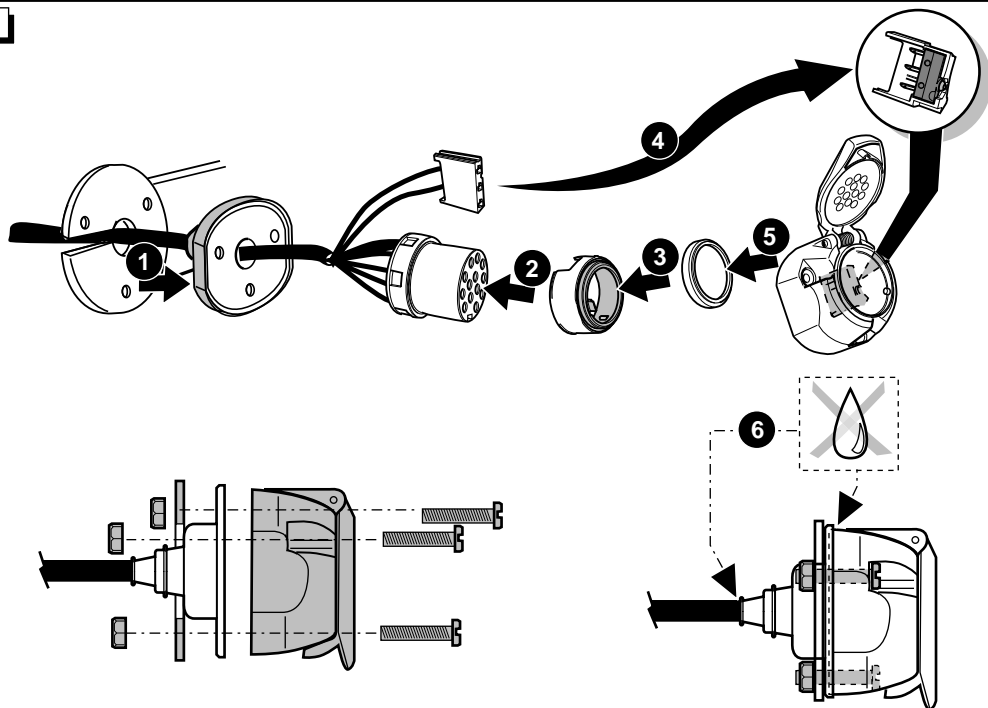

19

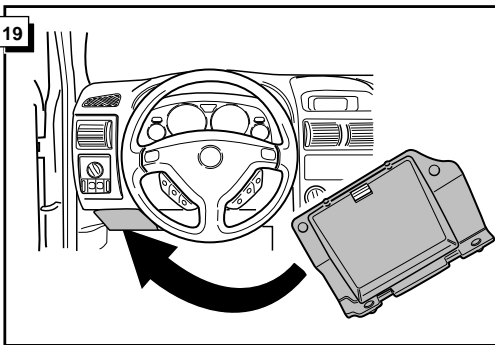

20

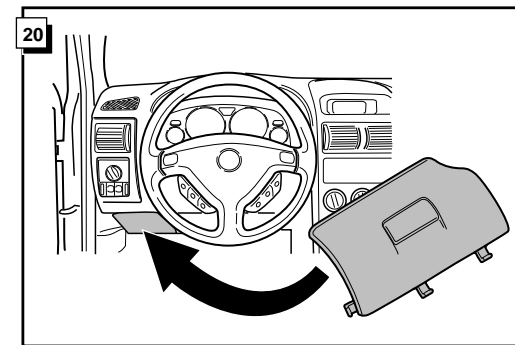

21

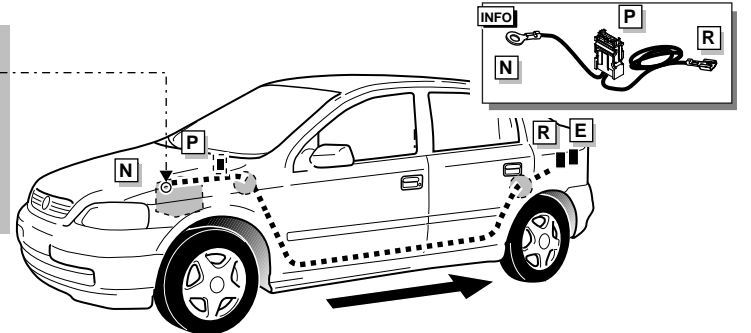
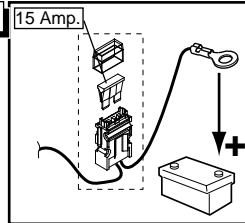

22

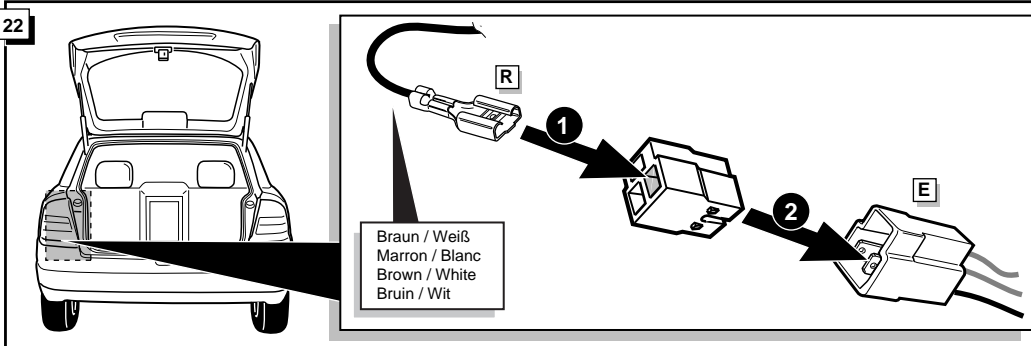

23

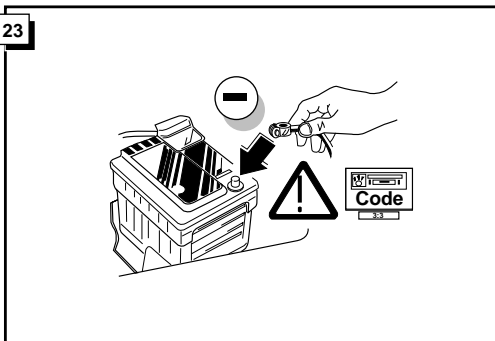

24

! FUNKTIONEN KONTROLLIEREN !
! CONTRÔLER LES FONCTIONS !
! CHECK FUNCTIONS !
! CONTROLEER FUNCTIES !

INFO

Abbildung 15 bis 20 ist nur für Modelle mit vorbereitetem Stecker im Gepäckraum.
Abbildung 21 und 22 ist nur für Modelle ohne vorbereiteten Stecker im Gepäckraum.

Figure 15 à 20 est seulement pour des modèles avec un connecteur préparé au coffre.
Figure 21 et 22 est seulement pour des modèles sans connecteur préparé au coffre.

Picture 15 to 20 is only for vehicles with a prepared connector in the boot.
Picture 21 and 22 is only for vehicles without a prepared connector in the boot.

Afbeelding 15 t/m 20 is alleen voor modellen met een voorbereide stekker in de kofferruimte.
Afbeelding 21 en 22 zijn alleen voor modellen zonder voorbereide stekker in de kofferruimte.

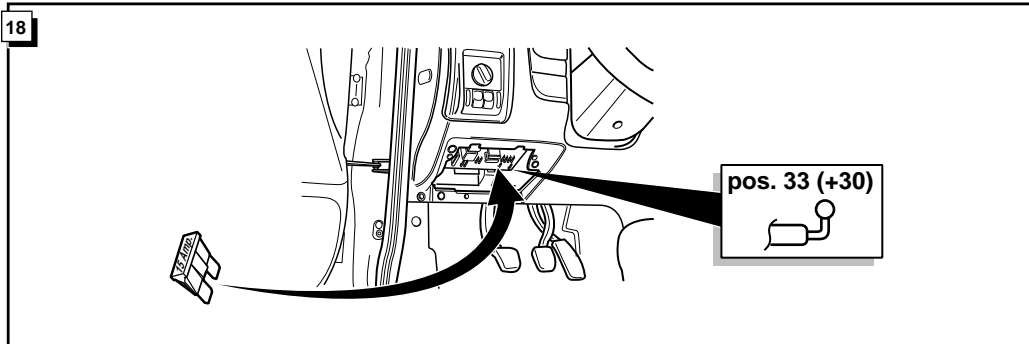
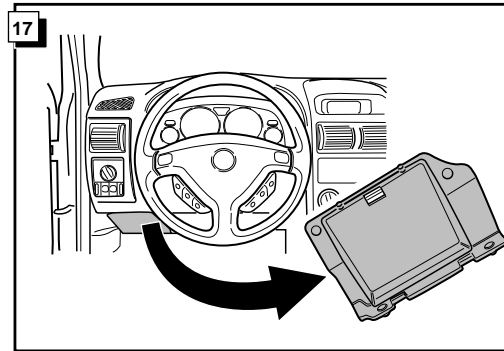
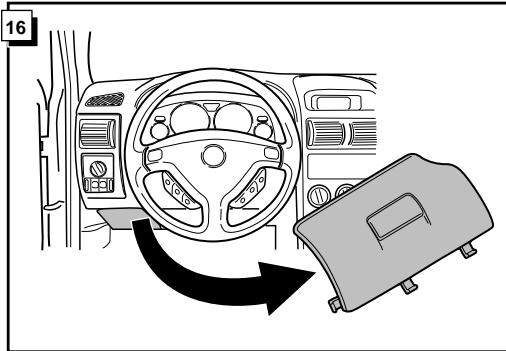
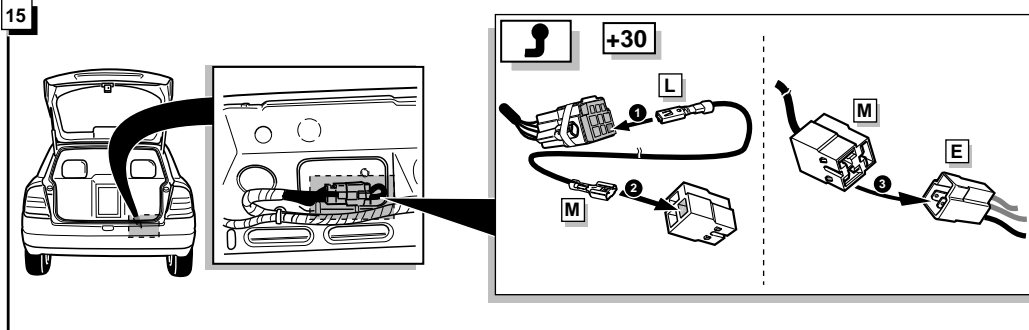

INFO Anschluß Steckdose / Connection de la prise / Socket connection / Contactdoos aansluiting

DIN/ISO 11446		(D)	(F)	(GB)	(NL)
←	1/L	gelb	jaune	yellow	geel
↶	2	blau	bleu	blue	blauw
↷	2a	grau	gris	grey	grijs
⏏	1-8	weiß	blanc	white	wit
↷	4/R	grün	vert	green	groen
☀	5/58-R	braun	marron	brown	bruin
STOP	6/54	rot	rouge	red	rood
☀	7/58-L	schwarz	noir	black	zwart
↶↷	8	schwarz/rot	noir/rouge	black/red	zwart/rood
↶↷	9	braun/weiß	marron/blanc	brown/white	bruin/wit
↶↷	10	rot	rouge	red	rood
⏏	11	weiß	blanc	white	wit
↶↷	12	rot/blau	rouge/bleu	red/blue	rood/blauw
⏏	13	weiß	blanc	white	wit

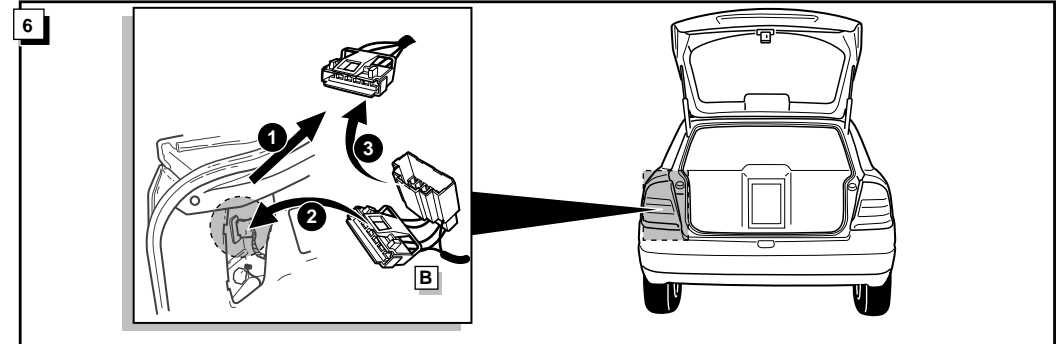
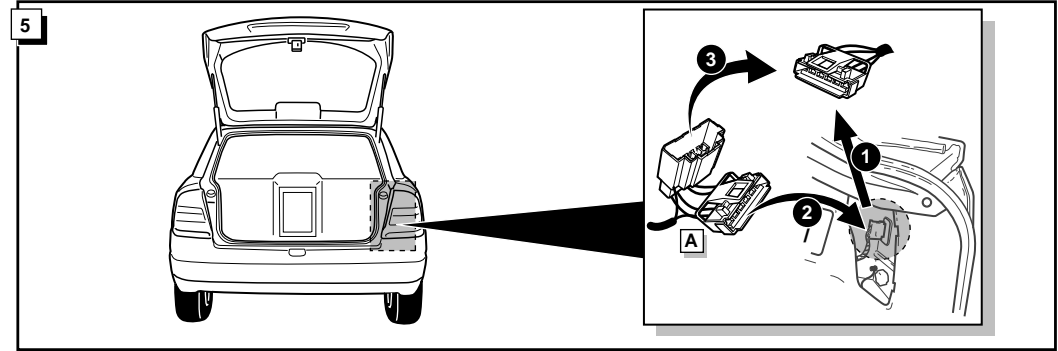

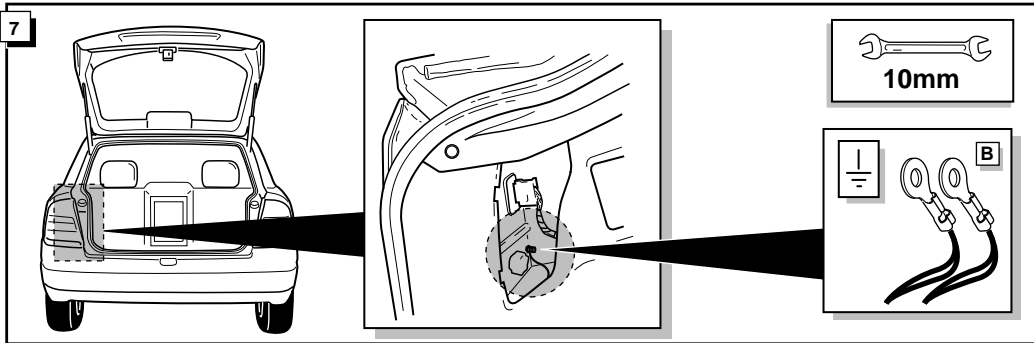

INFO

- * Fahrzeuge mit check control: bei Abbildung 8 weitergehen.
Fahrzeuge ohne check control: bei Abbildung 15 weitergehen.
- * Véhicules avec check control: continuez chez figure 8.
Véhicules sans check control: continuez chez figure 15.
- * Vehicles with check control: continue at picture 8.
Vehicles without check control: continue at picture 15.
- * Voertuigen met check control: ga verder bij afbeelding 8.
Voertuigen zonder check control: ga verder bij afbeelding 15.

8

- * **Mit Check control:** bei ihrem Lieferanten nach einem Erweiterungssatz informieren.
- * **Avec check control:** Informez chez votre fournisseur pour un faisceau d'extension.
- * **With check control:** contact your supplier for an extension kit.
- * **Met check control:** informeer bij uw leverancier naar een uitbreidingsset.

INFO

Erweiterungssatz für Fahrzeuge mit Check Control.
Faisceau d'extension pour véhicules avec check control.
Extension kit for vehicles with check control.
Uitbreidingsset voor voertuigen met check control.

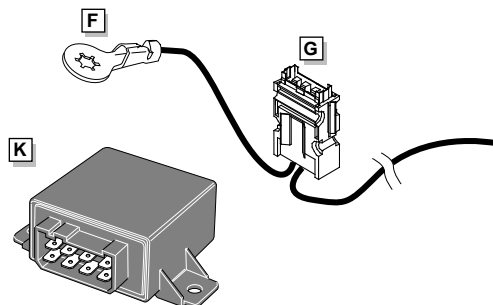

ROUTING

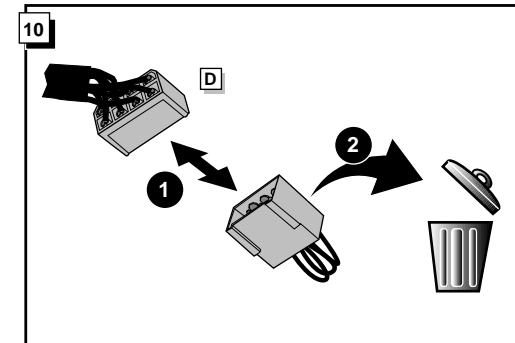
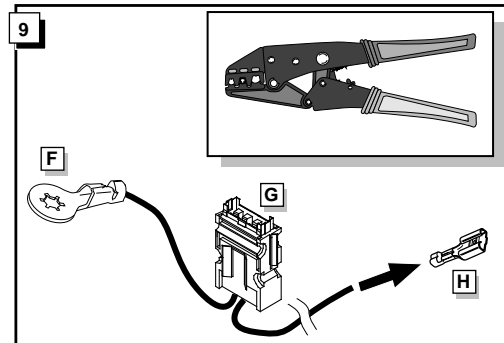
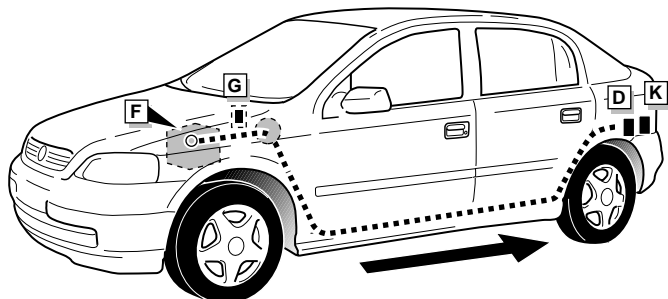

11

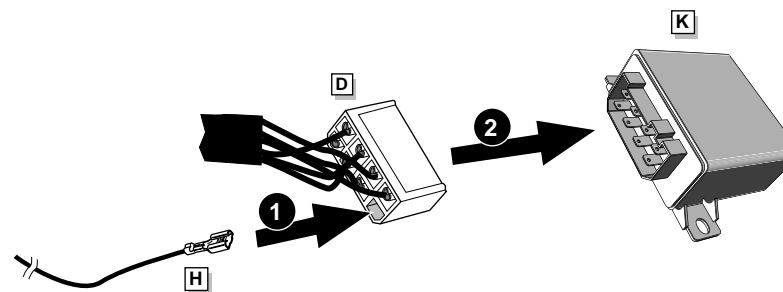

12

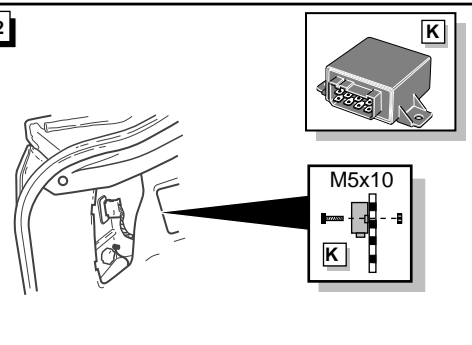

13

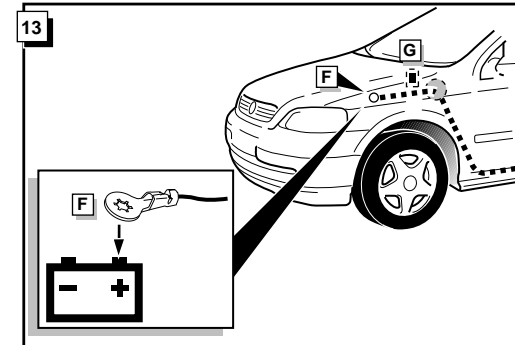

14

